

Combinazione SLU 1

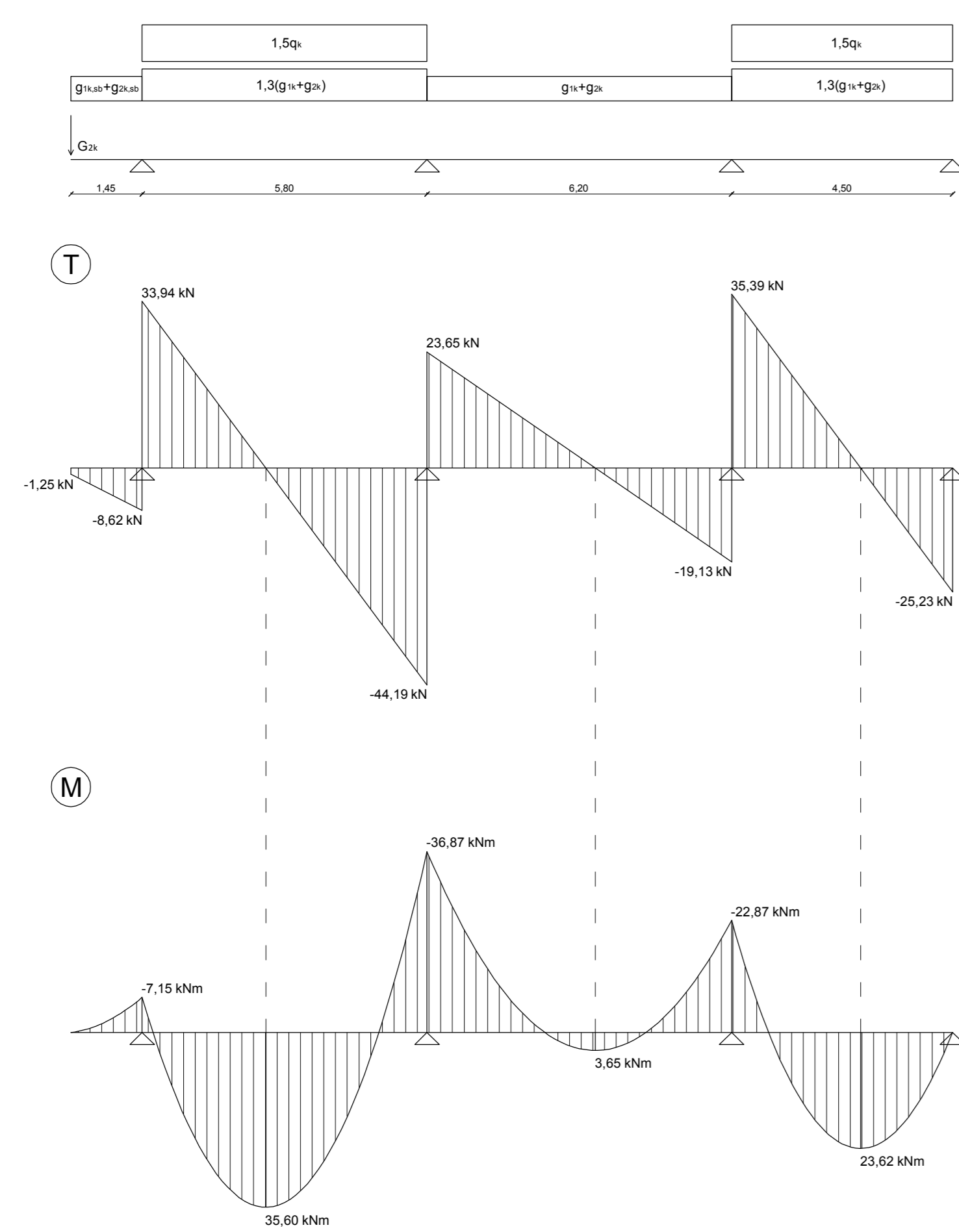

Combinazione SLU 2

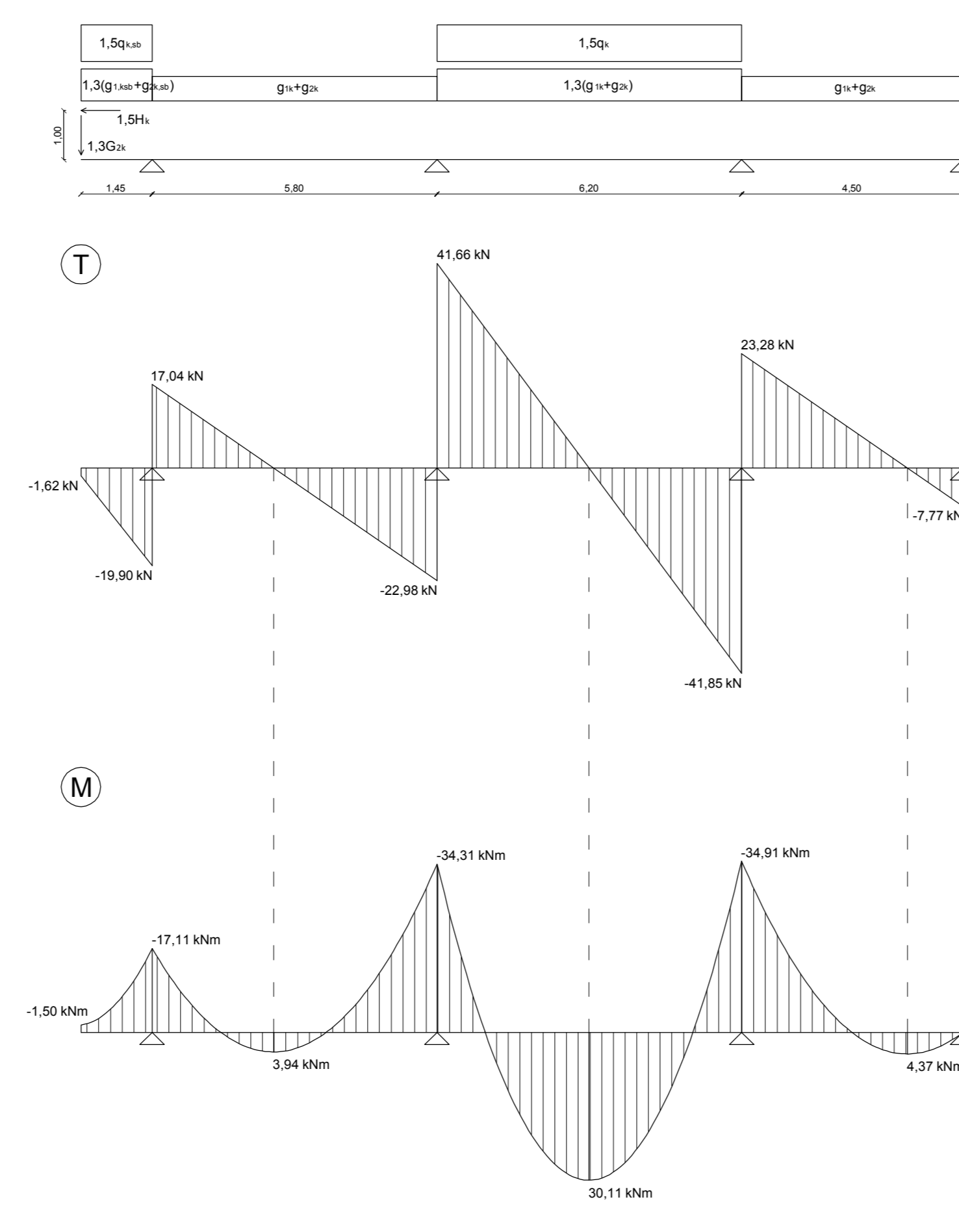

Combinazione SLU 3

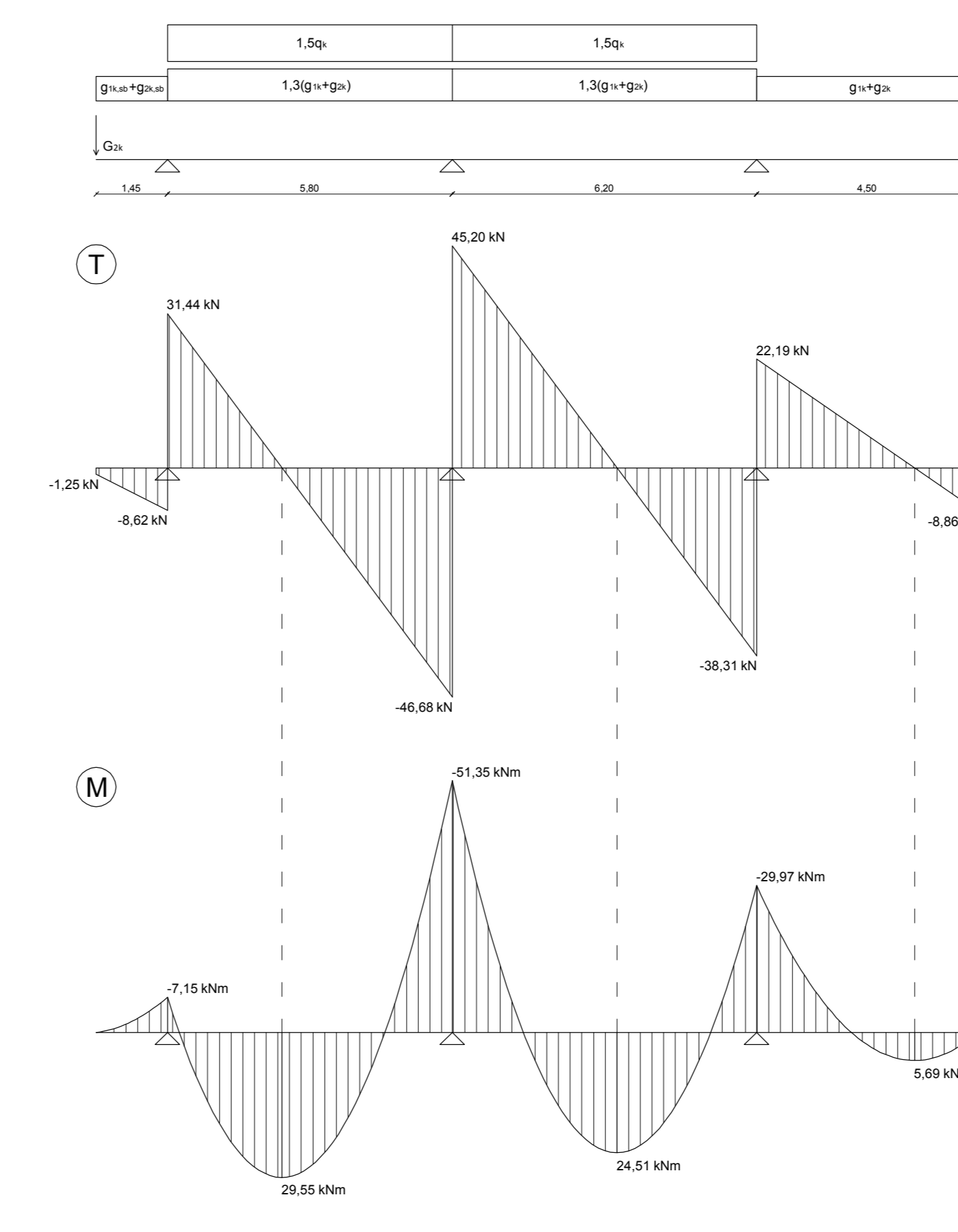

Combinazione SLU 4

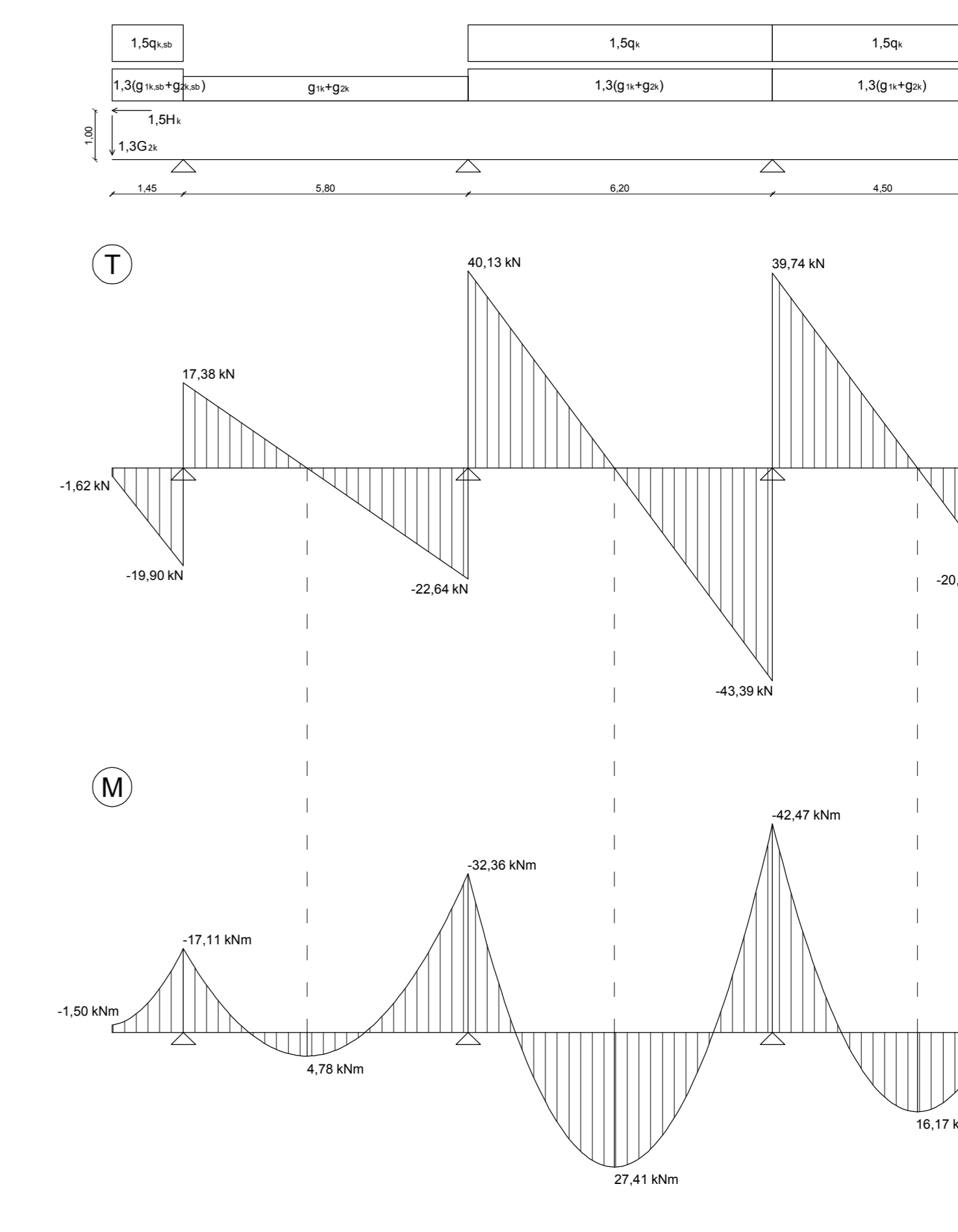

Combinazione SLE 1 (rara)

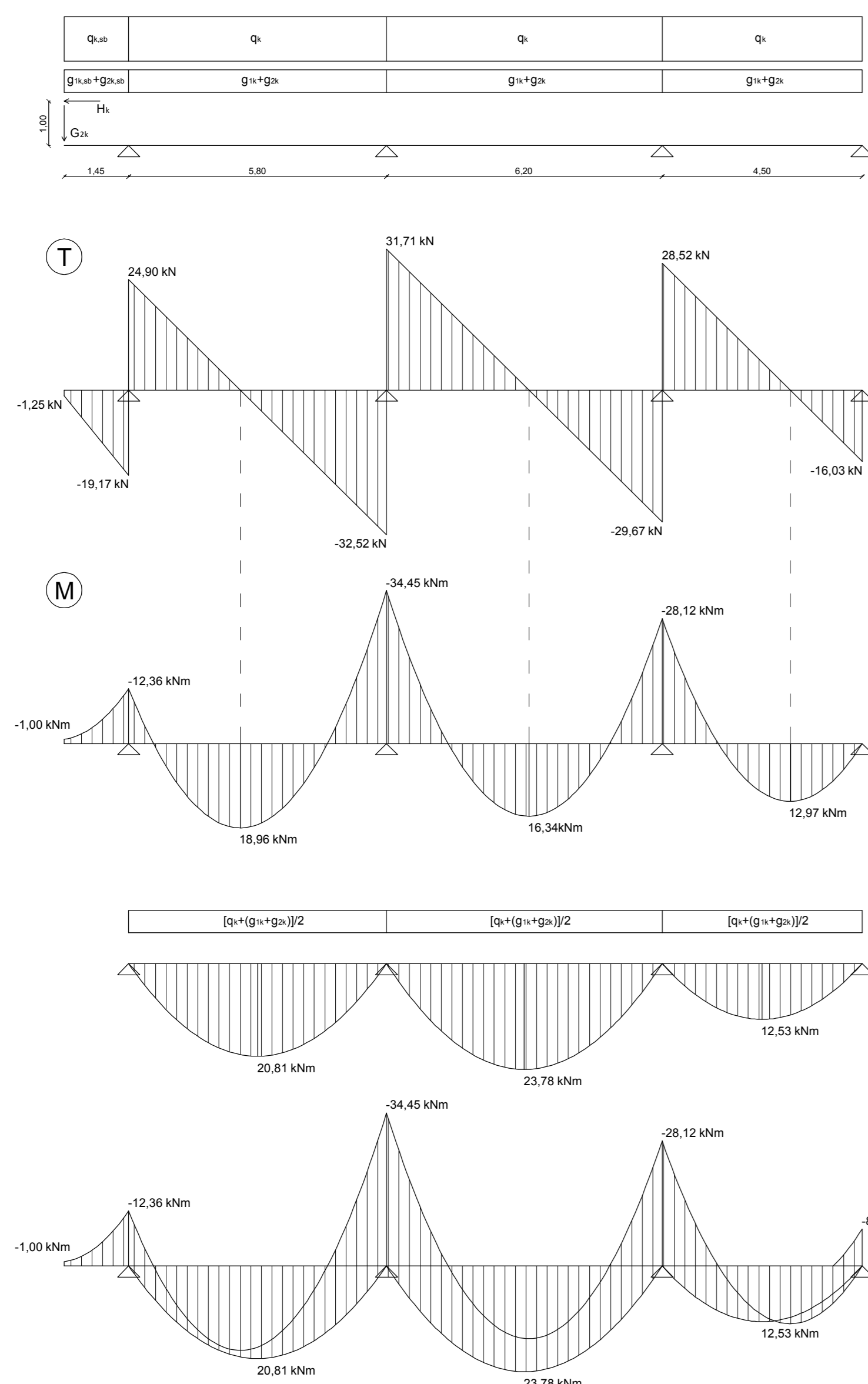

Combinazione SLE 2 (frequente)

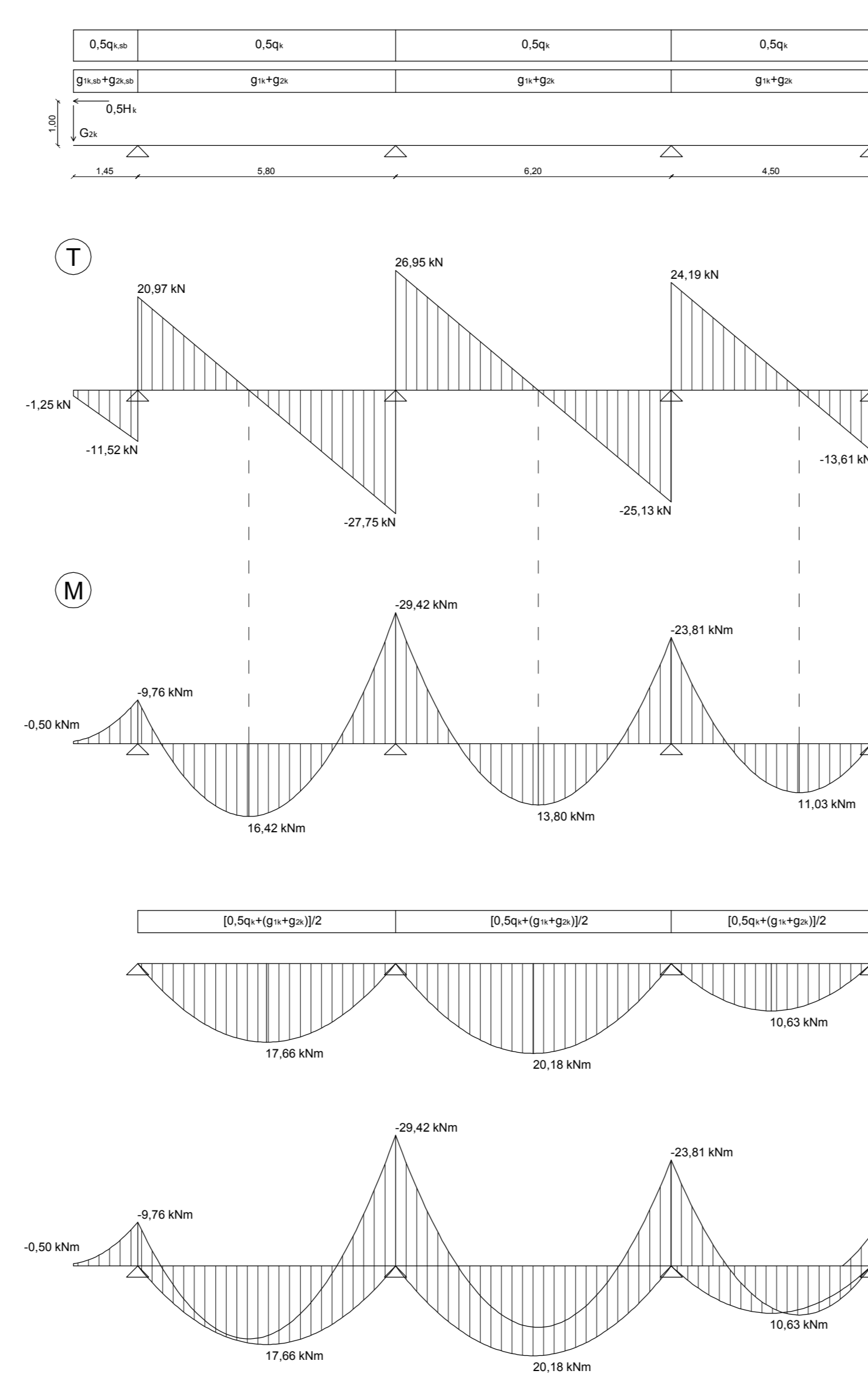

Combinazione SLE 3 (quasi permanente)

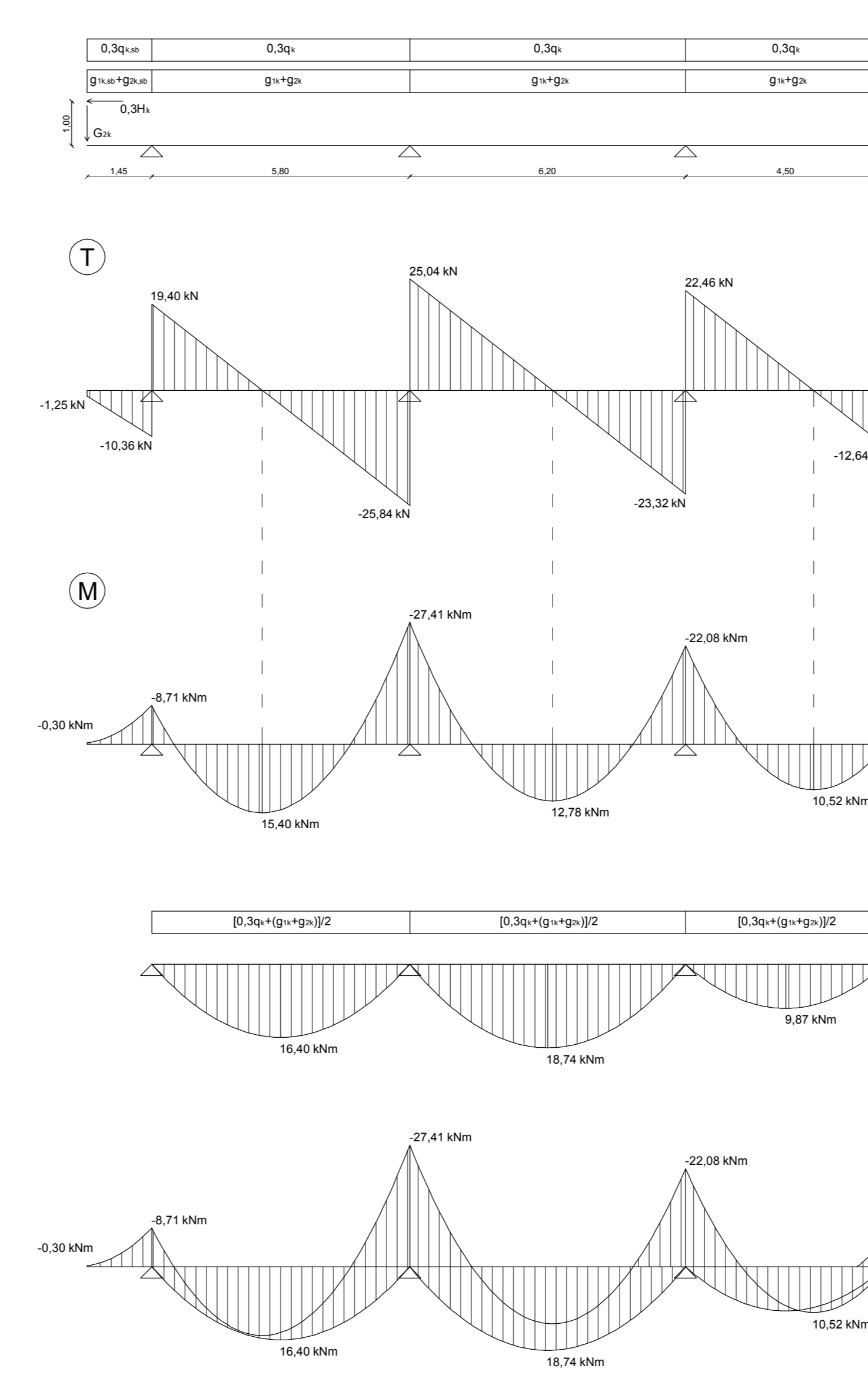

INVILUPPO DELLE SOLLECITAZIONI TAGLIANTI (SLU)

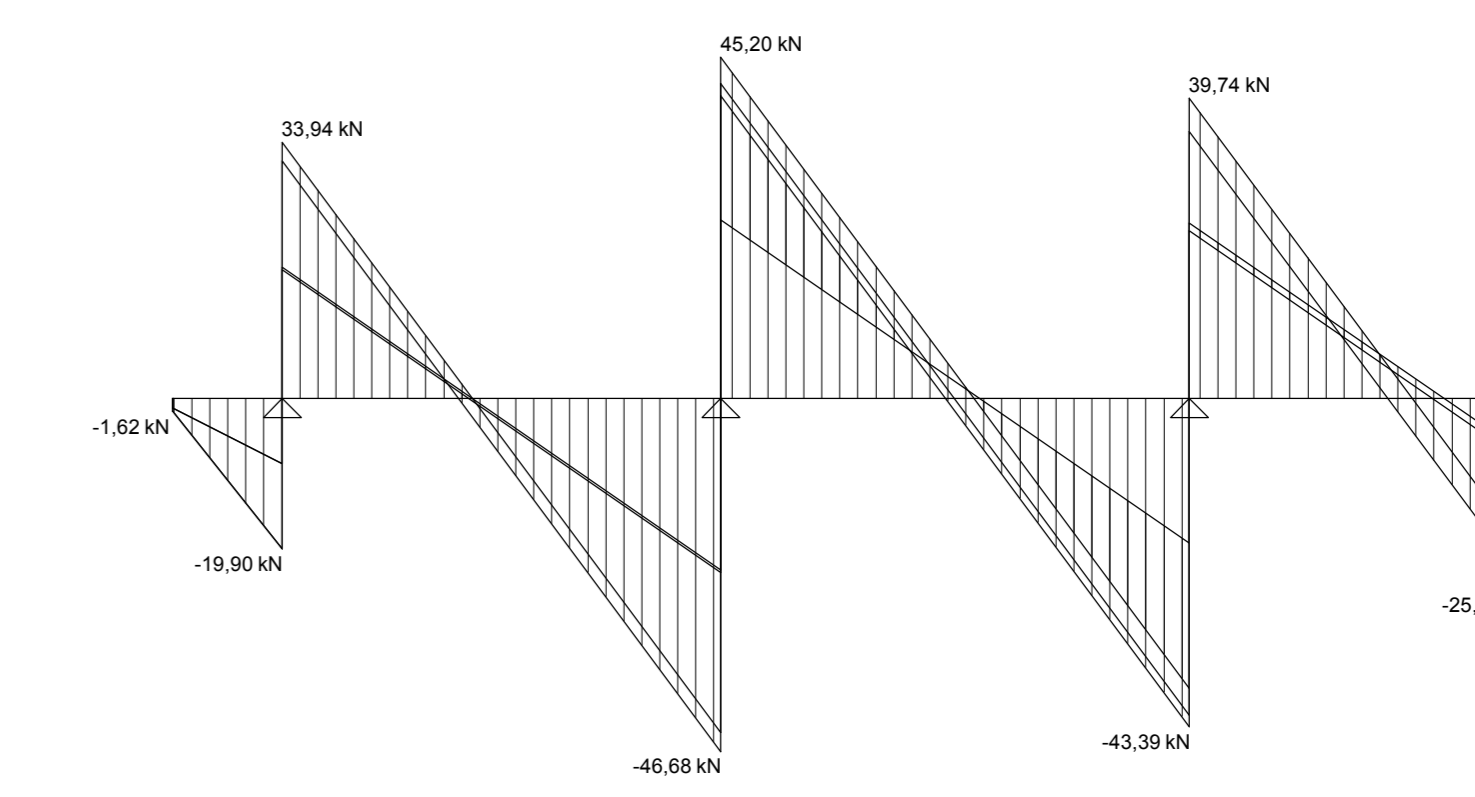

INVILUPPO DEI MOMENTI FLETTENTI (SLU)

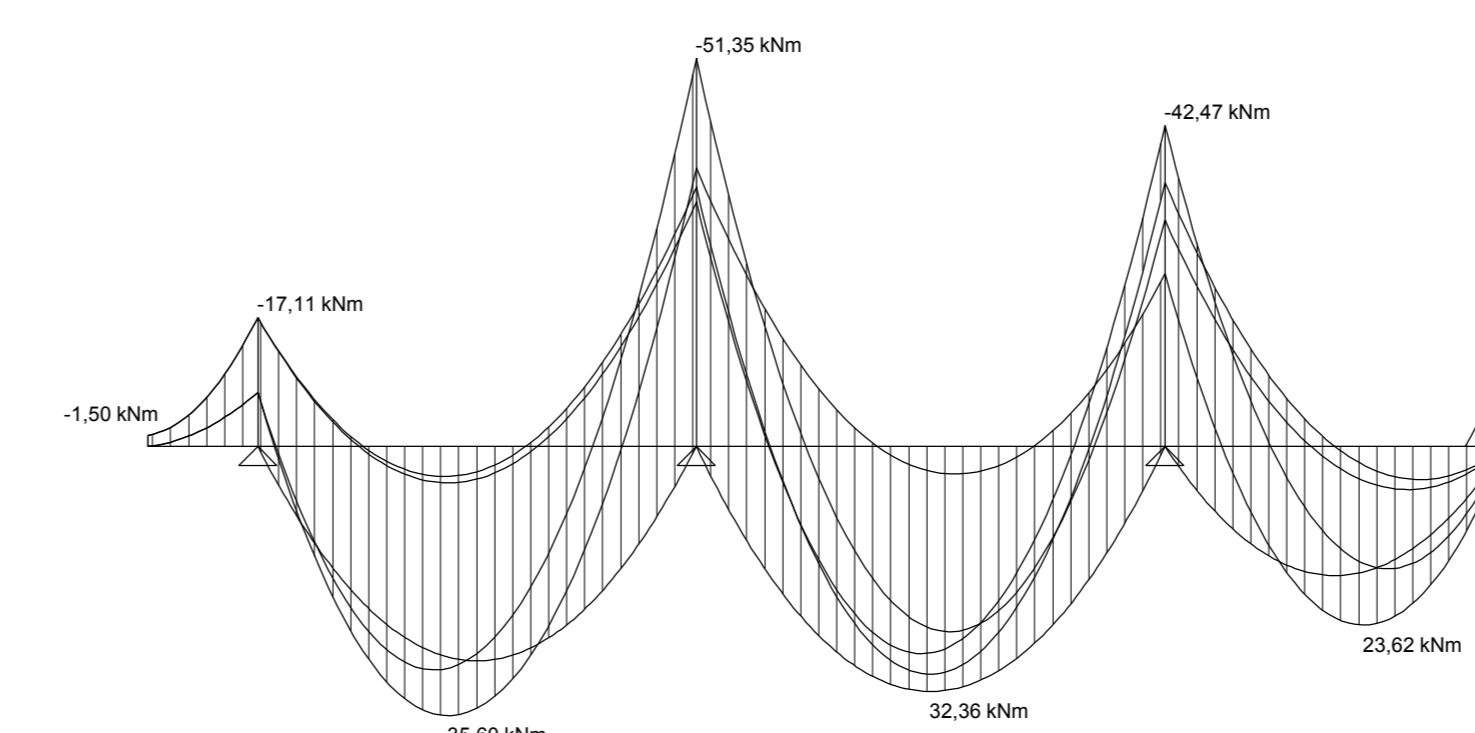
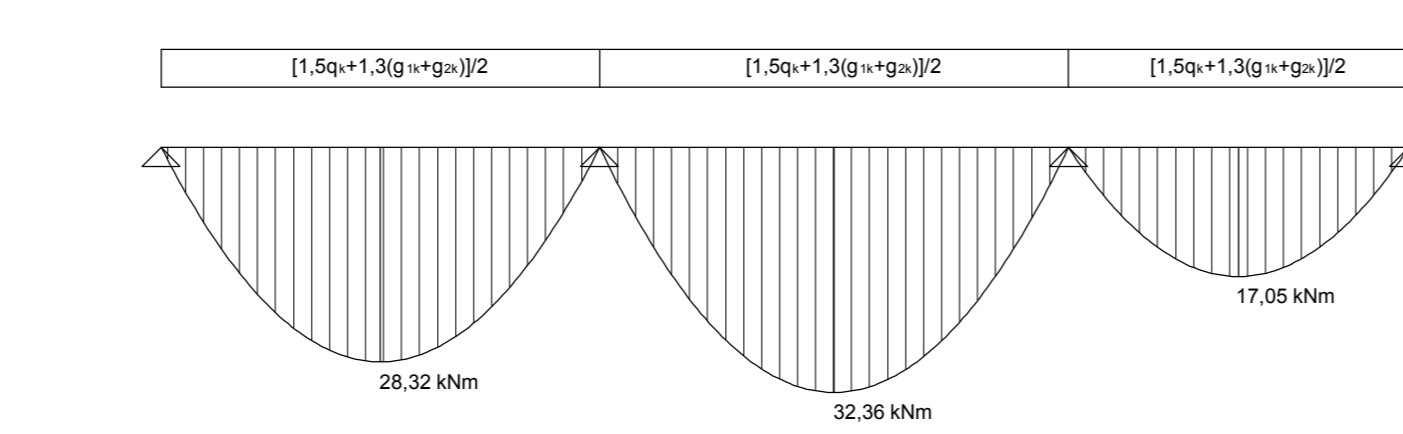
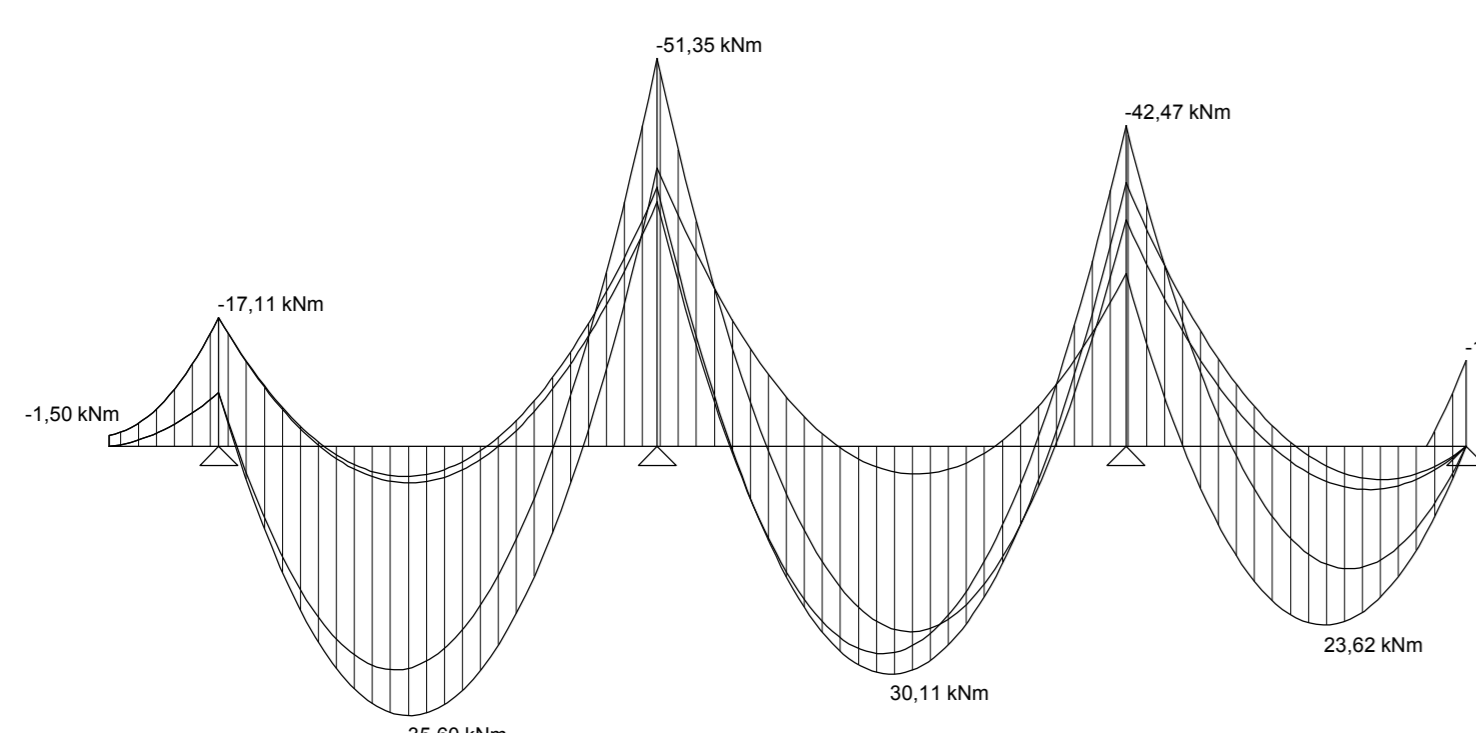

LEGENDA	
$q_{k,0}$	3,34 kN/m ²
$q_{k,10}$	1,74 kN/m ²
$q_{k,20}$	4,00 kN/m ²
g_k	3,86 kN/m ²
g_k	3,04 kN/m ²
q_k	3,00 kN/m ²
G_k	1,25 kN/m
H_k	1,00 kN/m

UNIVERSITÀ DEGLI STUDI DI SALERNO
FACOLTÀ DI INGEGNERIA

corso di TECNICA DELLE COSTRUZIONI I
anno accademico 2015/16

**PROGETTO DI UN SOLAIO
LATERO-CEMENTIZIO GETTATO IN OPERA**

ELABORATO n. **1**

DIAGRAMMI DELLE SOLLECITAZIONI

Scala delle Lunghezze 1 cm = 1 m (1:100)
Scala dei Momenti 1 cm = 10 kNm
Scala dei Tagli 1 cm = 10 kN

Docenti: Prof. Ing. Ciro Faella
Prof. Ing. Enzo Martinelli
Dott. Ing. Carmine Lima

Studenti: XXXXXXXX xxxxxxxx
XXXXXXXX xxxxxxxx